



CANTER SURVEYING & MAPPING

PHONE (614) 592-5706

GPS SERVICES

FAX (614) 592-5817

227A COLUMBUS ROAD
ATHENS, OHIO 45701

Tract 1

Situate in Section 14, Town 8, Range 14, Lease Lot 3, Alexander Township, Athens County, Ohio. Being the Clara Belle Van Nest parcel as described in Vol. 77 Page 702 of Athens County Deed Records and being more fully described as follows:

Point-of-Beginning being an iron pin set N 05°45'21" E 405.86 feet from the southwest corner of said Lease Lot 3;

Thence from this Point-of-Beginning along the west line of said Lease Lot 3 N 05°45'21" E 1128.90 feet to an iron pin set (reference: stone found at 346.84 feet);

Thence S 84°14'39" E 265.06 feet to an iron pin set;

Thence N 05°45'59" E 203.00 feet to an iron pin set at the Grantor's northwest corner and the southwest corner of a 56.85 acre tract described in Deed Records Vol. 214 Pg. 92;

Thence along the Grantor's north line S84°38'19" E 1299.05 feet to an iron pin set at the Grantor's northeast corner;

Thence along the Grantor's east line and the west line of a 64.05 acre tract described in Deed Records Vol. 214 Pg. 92 S 05°15'51" W 1724.89 feet to an iron pin set at the Grantor's southeast corner;

Thence along the Grantor's south line and the north line of an 88.05 acre tract described in Deed Records Vol. 307 Pg. 217 N 85°02'17" W 851.36 feet to an iron pin set;

Thence N 03°27'27" W 355.92 feet to a 36" Hickory (reference: iron pin set at 345.92 feet);

Thence N 53°32'06" W 278.59 feet to an iron pin set (reference: iron pin set at 10.00 feet);

Thence S 82°58'16" W 442.08 feet to the Point-of-Beginning.

Containing 54.162 acres as surveyed 12-30-1996 under the direction of Robert C. Canter, P.S. 7226.

Said parcel to be continuous and contiguous with James and Karen Dailey 12.23 acre tract described in Vol. 333 Page 205, Athens County Deed Records.

Prepared for
Survey
B. Blawie
1-18-97

Plot 14



Also including an easement for ingress and egress 25.00 feet in width, the centerline of said easement being described as follows:

Point-of-Beginning being a point in the center of Alexander Township Road 47, said Point-of-Beginning being N 05°45'21" E 83.22 feet, thence S 25°19'19" E 76.12 feet from the southwest corner of Lease Lot 3;

Thence from this Point-of-Beginning the following three courses:

S 85°02'17" E 41.88 feet to a point,
N 57°55'28" E 288.55 feet to a point,
S 89°47'57" E 384.25 feet to a point.

Subject to all legal easements and right of ways.

Iron pins set are 5/8" x 30" rebar with cap stamped "CANTER 7226".

Plat of Survey is attached herewith and made a part thereof.

Basis of Bearings: Based on previous survey by Leonard F. Swoyer, P.S. 6765. Bearings are used to denote angular relationships only.

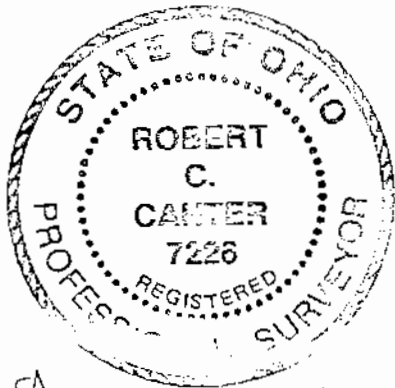

Robert C. Canter

ACREAGE, CLOSURE, AND ERROR OF PLAT

Line #	Direction	Angle	Distance	Error	Direction	Distance
1	South	84°	38'	19"	East	1,299.05 feet.
2	South	05°	15'	51"	West	1,724.89 feet.
3	North	85°	02'	17"	West	851.36 feet.
4	North	03°	27'	27"	West	355.92 feet.
5	North	53°	32'	06"	West	278.59 feet.
6	South	82°	58'	16"	West	442.08 feet.
7	North	05°	45'	21"	East	1,128.90 feet.
8	South	84°	14'	39"	East	265.06 feet.
9	North	05°	45'	59"	East	203.00 feet.

The easting error is 0.01 feet.

The northing error is -0.01 feet.

The gap in closure is 0.01 feet.

The precision of the field survey is
0.02 feet error per 10,000 feet traverse.

The area computes to be 54.16 acres.

13

Tract 2

Situate in Section 14, Town 8, Range 14, Lease Lot 3 Alexander Township, Athens County, Ohio. Being the Clara Belle VanNest parcel as described in Vol. 77 Page 702, Athens County Deed Records and being more fully described as follows:

Point-of-Beginning being an iron pin set at the southwest corner of said Lease Lot 3;

Thence from this Point-of-Beginning along the west line of said Lease Lot 3 N 05°45'21" E 405.86 feet to an iron pin set (reference: R/R spike found in the center of Township Road 47 at 83.23 feet);

Thence N 82°58'16" E 442.08 feet to an iron pin set;

Thence S 53°32'06" E 278.59 feet to a 36" Hickory (reference: iron pin set at 268.59 feet);

Thence S 03°27'27" E 355.92 feet to an iron pin set in the Grantor's south line (reference: iron pin set at 10.00 feet);

Thence along the Grantor's south line N 85°02'17" W 727.71 feet to the Point-of-Beginning.

Containing 7.038 acres as surveyed 12-30-1996 under the direction of Robert C. Canter, P.S. 7226.

Excepting an easement for ingress and egress 25.00 feet in width, the centerline of said easement being described as follows:

Point-of-Beginning being a point in the center of Alexander Township Road 47, said Point-of-Beginning being N 05°45'21" E 83.22 feet, thence S 25°19'19" E 76.12 feet from the southwest corner of Lease Lot 3;

Thence from this Point-of-Beginning the following three courses:

S 85°02'17" E 41.88 feet to a point,
N 57°55'28" E 288.55 feet to a point,
S 89°47'57" E 384.25 feet to a point.

Subject to all legal easements and right of ways.

Iron pins set are 5/8" x 30" rebar with cap stamped "CANTER 7226".

Plat of Survey is attached herewith and made a part thereof.

Basis of Bearings: Based on previous survey by Leonard F. Swoyer, P.S. 6765. Bearings are used to denote angular relationships only.

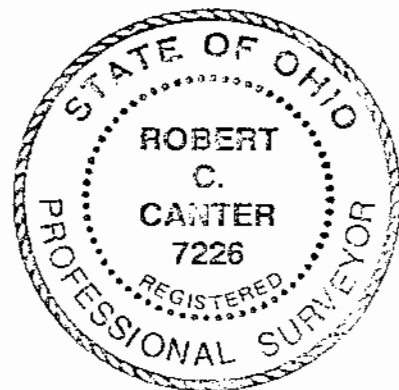

And for
recording
FILE
S. Blausen
1-18-97

ALX* 14

PLAT of SURVEY

Basis of Bearing: Based on previous survey by Leonard F. Swoyer P.S. 6765 As described in Vol.51 pg.502 of Athens County Deed Records. Bearings are used to denote angular relationships only.

Situated in Section 14, T. 8, R. 14, Lease Lot 3, Alexander Township, Athens County, Ohio.

Being the Clara Belle VanNest parcel as described in Vol.77 pg.702 of Athens County Deed Records

Tract 1 containing 54.162 Acres and Tract 2 containing 7.038 Acres As surveyed under the direction of Robert C. Canter P.S. 7226

Point-of-Beginning being an Iron pin set at the Southwest corner of Lease Lot 3



Boyd R. Cooley
214-92 & 262-80,81

Ernest R. & Cynthia A. Perry
45-69

James M. & Karen Dailey
333-205

Alicya J. Shade
150-620

P.O.B.
I.P. SET AT
SOUTH WEST
CORNER OF
LEASE LOT 3

Ralph M. Daines
307-217

TRACT 1 = 54.162 ACRES
Tract 1 is to be continuous and contiguous with James and Karen Dailey 12.23 Acre tract as described in Vol. 333 pg.205 of Athens County Deed Records.

Boyd R. Cooley
214-92 & 262-80,81

Center Line of Ingress & Egress easement.

Point-of-Beginning being a point in the Center of Twp. road 47 Said Point-of-Beginning being N 05°45'21" E 83.22 feet, Thence S 25°19'19" E 76.12 feet from the S.W. corner of Lease lot 3

Thence the following courses
L3 S 85°02'17" E 41.88'
L4 N 57°55'28" E 288.55'
L5 N 89°47'57" W 384.250'

S. Blaise
1-10-97

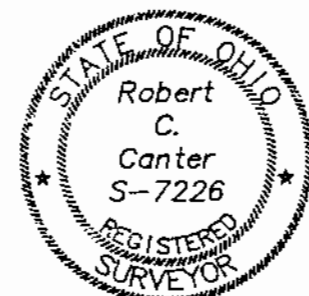

GRAPHIC SCALE

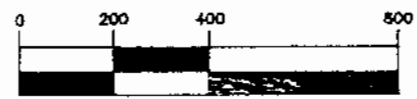

(IN FEET)
1 inch = 400 ft.

- IRON PIN SET - 5/8" X 30" REBAR w/CAP STAMPED "CANTER 7226"
- △ RAIL ROAD SPIKE FOUND
- STONE FOUND

Subject to all legal easements and right-of-ways.

Robert C. Canter

DRAWN BY	M. Schloss	DATE	12-30-96
CHECKED BY	RCC	DRAWING NO.	96103.DWG
SEE PLAN	96103	SHEET	1 of 1