



# **ROBINSON SURVEYING**

MEMBER-PROFESSIONAL LAND SURVEYORS OF OHIO  
12355 LIARS CORNER ROAD, MILLFIELD, OHIO 45761

ALAN D. ROBINSON  
Registered Land Surveyor

TELEPHONE  
(740) 593-8774

## ***DESCRIPTION OF A 1.144 ACRE TRACT***

Situated in Section 25, Town 6, Range 12, Rome Township, Athens County, Ohio, and being a part of a 25.390 acre tract Surveyed by Alan D. Robinson P.S. 8049 March 26, 2001 and being more particularly described as follows:

Commencing at an iron pin found at the Southeast corner of lot 30 in the Village of Guysville; thence South 2 degrees 28 minutes 14 seconds West, a distance of 375.70 feet to a point in the North Bank of the Hocking river; thence, following the North Bank of said River, South 87 degrees 28 minutes 55 seconds East, a distance of 49.50 feet to an iron pin set; thence North 2 degrees 27 minutes 59 seconds East, a distance of 401.31 feet to an iron pin found; thence, North 2 degrees 27 minutes 59 seconds East along said line, a distance of 104.36 feet to an iron pin found, said iron pin found being the point of curvature of a non-tangent curve, concave to the north, having a radius of 5679.58 feet, a central angle of 2 degrees 13 minutes 34 seconds, and a chord of 220.65 feet bearing North 74 degrees 37 minutes 54 seconds East; thence east along said curve, a distance of 220.66 feet to an iron pin found, said iron pin found being the POINT OF BEGINNING; thence North 16 degrees 43 minutes 21 seconds West, a distance of 69.82 feet to a point in State Route 329, passing an iron pin set at 36.82 feet; thence, following said State Route, North 66 degrees 56 minutes 31 seconds East, a distance of 386.19 feet to a point; thence North 65 degrees 58 minutes 44 seconds East, a distance of 147.83 feet to a point; thence, leaving said Road, South 24 degrees 13 minutes 01 second East, a distance of 108.28 feet to a point, said point being the point of curvature of a non-tangent curve, concave to the north, having a radius of 5679.58 feet, a central angle of 5 degrees 30 minutes 04 seconds, and a chord of 545.11 feet bearing South 70 degrees 46 minutes 05 seconds West; thence west along said curve, a distance of 545.32 feet to the POINT OF BEGINNING, passing an iron pin set at 50.00 feet; said described tract containing 1.144 acres (49,818.7179 square feet).

Bearings are based on previous Surveys and are used to denote angles only.  
Subject to all easements and right-of-way of record.

All iron pins set are 5/8 inch by 30-inch long rebar with a yellow cap stamped Alan Robinson RLS 8049.

Alan D. Robinson P.S. 8049 bases the above description on a field Survey completed March 26, 2001,

*Alan D. Robinson*

Description checked for  
Mathematical Accuracy  
ATHENS COUNTY  
ENGINEER'S OFFICE  
BY: *S. Blause*  
DATE: *3-26-01*



# ROBINSON SURVEYING



12355 Liars Corner Rd.  
Millfield, Ohio 45761  
(740) 593-8774  
1-800-296-9984

Darin M. &  
Kellie L.  
Hayden  
266-1136 O.R.

Darin M. &  
Kellie L.  
Hayden  
207-278 O.R.

Richard L.  
Hines  
241-480 O.R.

Steve E. & Tamara K.  
Lucas  
142-4 O.R.  
376-569 D.R.

State Route 329

**1.144 Acres**

Steve E. & Tamara K.  
Lucas 218-334 O.R.  
1.695 Acres Survey  
(1.704 Acres Deed)

James B.  
Hays  
113-754 O.R.

25.390 acres Surveyed  
By Alan D. Robinson P.S. 8049  
3/26/2001

Southeast corner  
of Lot 30 in the  
Village of Guysville

Curve	Delta Angle	Radius	Arc	Tangent	Chord	Chord Bearing
1	2°13'34"	5679.56	220.66	110.35	220.65	N 74°37'54" E
2	5°30'04"	5679.58	545.32	272.87	545.11	S 70°46'05" W
3	7°32'24"	5779.58	760.59	380.85	760.05	S 72°16'14" W

Line	Bearing	Distance
1	S 87°28'55"E	49.50'
2	N 16°43'21"W	69.82'

S 2°28'14"W  
375.70'

N 2°27'59"E  
401.31'

- = Iron Pin Set W/A Yellow Cap  
Stamped Alan Robinson RLS 8049
- = Iron Pin Found
- △ = Rail Road Spike Set
- ▲ = Rail Road Spike found
- ⊠ = Stone Found
- M = Measured
- D = Deed
- C = Calculated

Description checked for  
Mathematical Accuracy  
ATHENS COUNTY  
ENGINEER'S OFFICE  
BY: *S. Blauzer*  
DATE: *3-26-01*

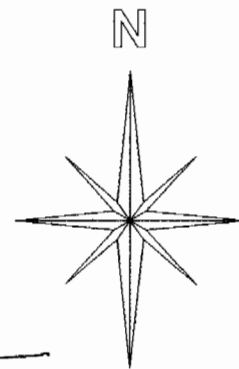

Graphic Scale



1 INCH = 100 FEET

**References**

Deeds as Noted  
Previous Surveys  
Current Tax Plats  
Existing Monumentation

**BEARING REFERENCE**

BASED ON PREVIOUS SURVEYS AND  
ARE USED TO DENOTE ANGLES ONLY

Plat of Survey of a 1.144 Acre tract

Surveyed for: James Hays Date 03/26/2001

Subdivision:-----

Section 25, Town 6, Range 12, Rome Township

Athens County, State of Ohio

Alan D. Robinson Registered Professional Land Surveyor No. 8049

*Alan D. Robinson*

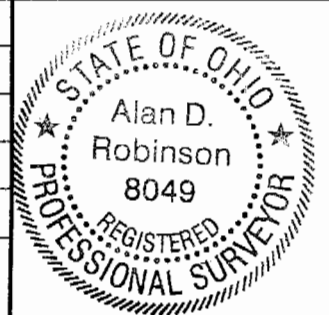

Rom #25